

Chantrolle®



3 IN 1 ROLLER STAND

MODEL NO: CARS3IN1HD

PART NO: 6500983

OPERATION & MAINTENANCE INSTRUCTIONS

ORIGINAL INSTRUCTIONS

GC0624

ASSEMBLY INSTRUCTIONS

Necessary tools supplied:

- 4mm and 5mm hex wrenches
- Open wrench

Unpack the components and lay them out to confirm that all items are present and not damaged in shipment. Complete assembly before discarding the box.

1. Fasten the two support legs (2) to the centre bracket (1) with the M8x45 bolts (3). Use an M8 washer (5) and M8 lock nut (4) to assemble as shown in Figure 1. Gently tighten using the 5mm hex wrench while the open wrench holds the nut secure.
2. Feed the M6 x 45mm bolts (7) through the horizontal beams (6) noting that the rubber feet face downwards. Attach the beams to each support leg (2) as shown in Figure 2.
3. Tighten the bolts with the 4mm hex wrench.
4. Repeat steps 1 – 3 for the other support leg assembly.
5. Insert the upright post (9) into the center bracket (1) with 2 holes at the top.
6. Screw the locking handle (10) into position and tighten to secure the position of the post as in Figure 3.
7. Spread the stand legs apart and stand the assembly on the ground. Attach the roller bracket (11) using two M6 x 35 bolts (12) locknuts (13) and washers (14) as shown in Figure 4.

Figure 1

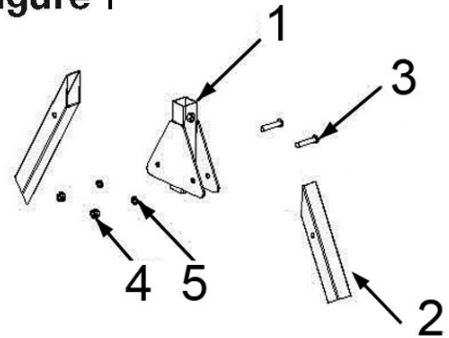

Figure 2

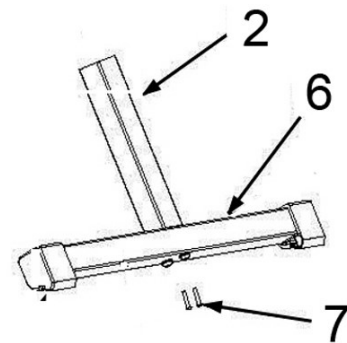

Figure 3

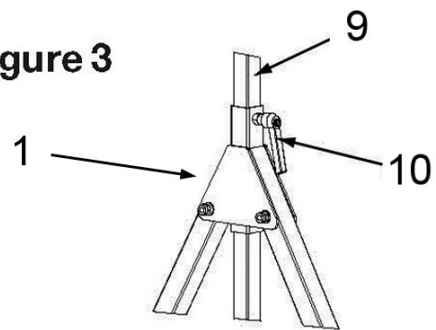
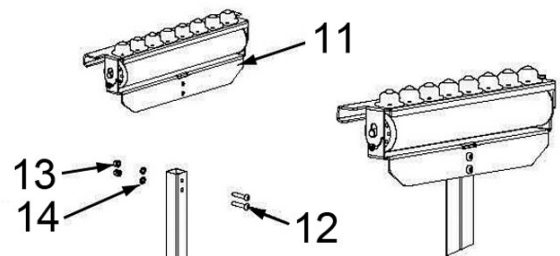

Figure 4



USER INSTRUCTIONS

Setting up the roller stand properly is essential for safe use. This stand is designed to support the maximum weight of 136kg at the maximum height setting.

1. **DO NOT** overload the stand.
2. Be sure the stand legs are fully opened and situated on a flat level surface.
3. Ensure the stand height is set level to the bottom of the workpiece for stability.
4. Ensure that the locking handle is fully tightened before using the stand.
5. It is extremely dangerous to loosen the locking handle while the stand is supporting a load.
 - Make sure that the locking handle is properly tightened before use.
 - **DO NOT** use the stand as a step ladder or scaffold.
6. **NEVER** use the product if any parts are missing.

ADJUSTING THE 3-IN-1 ROLLER HEAD

The 3-in-1 roller head can be set in three different positions depending on the project and the shape of your workpiece. See Figure 5.

1. Position - 1: Flat surface up. Use this position if the workpiece needs to be supported but does not need to move such as in a gluing or assembly process.
2. Position - 2: Large roller surface up. Use this position when your project requires the workpiece to move only in one direction such as an infeed or outfeed support in a sawing process.
3. Position - 3: Ball bearing roller surface up. Use this position when the workpiece needs to move in more than one direction such as aligning a workpiece with a power tool or workbench.

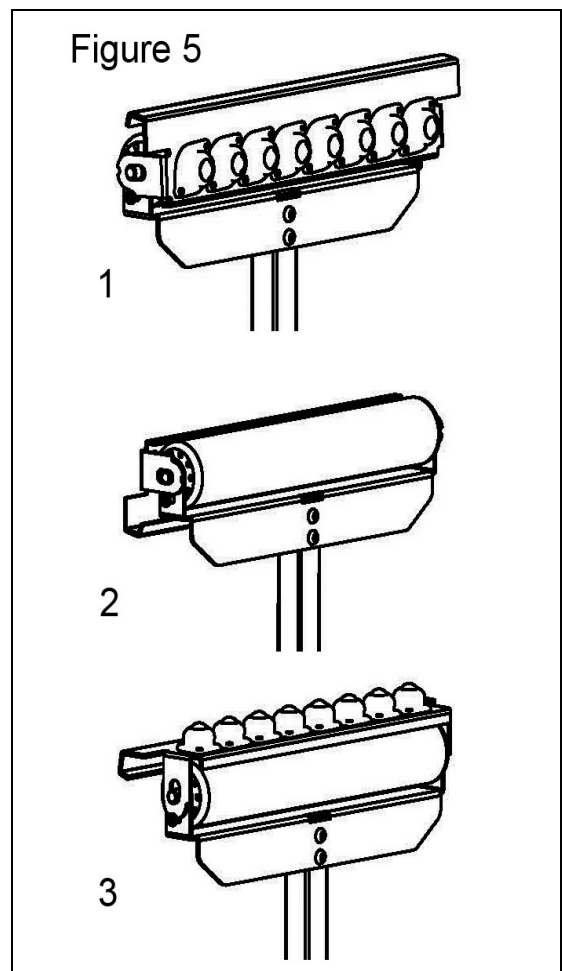

A SELECTION FROM THE VAST RANGE OF

Clarke®

QUALITY PRODUCTS

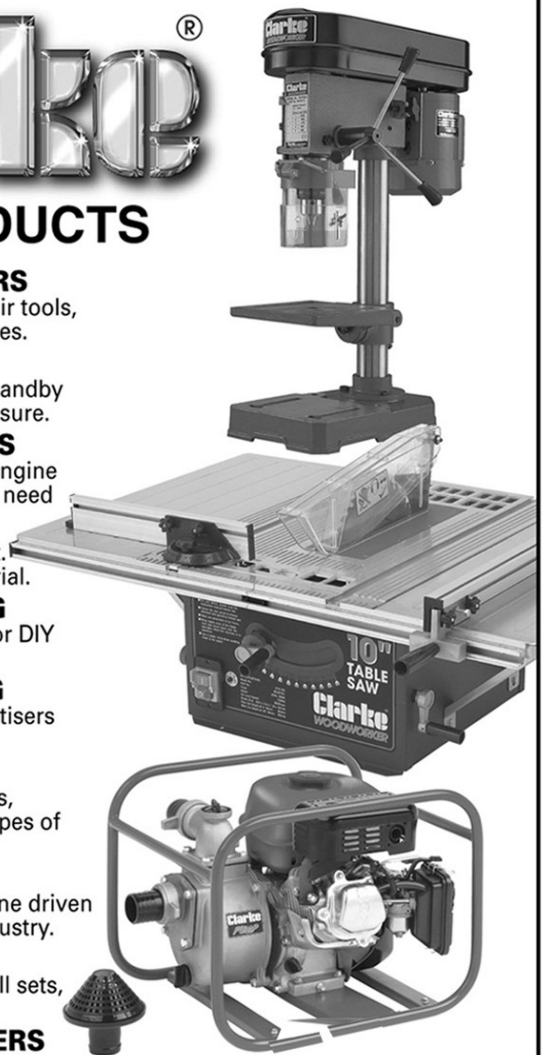

AIR COMPRESSORS

From DIY to industrial, Plus air tools, spray guns and accessories.

GENERATORS

Prime duty or emergency standby for business, home and leisure.

POWER WASHERS

Hot and cold, electric and engine driven - we have what you need

WELDERS

Mig, Arc, Tig and Spot. From DIY to auto/industrial.

METALWORKING

Drills, grinders and saws for DIY and professional use.

WOODWORKING

Saws, sanders, lathes, mortisers and dust extraction.

HYDRAULICS

Cranes, body repair kits, transmission jacks for all types of workshop use.

WATER PUMPS

Submersible, electric and engine driven for DIY, agriculture and industry.

POWER TOOLS

Angle grinders, cordless drill sets, saws and sanders.

STARTERS/CHARGERS

All sizes for car and commercial use.

Guarantee

This product is guaranteed against faulty manufacture for a period of 12 months from the date of purchase. Please keep your receipt which will be required as proof of purchase.

This guarantee is invalid if the product is found to have been abused or tampered with in any way, or not used for the purpose for which it was intended. Faulty goods should be returned to their place of purchase, no product can be returned without prior permission.

This guarantee does not affect your statutory rights.

PARTS & SERVICE: 020 8988 7400

E-mail: Parts@clarkeinternational.com or Service@clarkeinternational.com

SALES: UK 01992 565333 or Export 00 44 (0)1992 565335

Clarke® INTERNATIONAL Hemnall Street, Epping, Essex CM16 4LG
www.clarkeinternational.com